

POS.	DENOMINAZIONE	Q.TA'	DIS. N.	CODICE
66	VALVOLA SEMPRE LIBERO	2	6234	AH81760
65	MOLLA	2	6908	AM1226B
64	SPILLO VALVOLA SEMPRE LIBERO	2	6234 (MAT. 0158)	AP8202G
32	VALVOLA DI NON RITORNO	0	6235 (MAT. AVP)	AM11510
30	MOLLA	0	6240	AM1224B
29	TAPPO VALVOLA DI NON RITORNO	0	6235 (MAT. AVP)	AP1166G
26	O-RING 009 POLYPAC/OR 2021 A.P.	0	6235 (MAT. AVP)	AGG1420
16	SFERA 5/16 DIAM. 8 S1	0	---	AC1302K

VERSIONE SLAC

POS.	DENOMINAZIONE	Q.TA'	DIS. N.	CODICE
66	VALVOLA SEMPRE LIBERO	0	6234	AH81760
65	MOLLA	0	6908	AM1226B
64	SPILLO VALVOLA SEMPRE LIBERO	0	6234 (MAT. 0158)	AP8202G
32	VALVOLA DI NON RITORNO	2	6235 (MAT. AVP)	AH81760
30	MOLLA	2	6240	AM1224B
29	TAPPO VALVOLA DI NON RITORNO	2	6235 (MAT. AVP)	AP8205G
26	O-RING 009 POLYPAC/OR 2021 A.P.	2	6235 (MAT. AVP)	AGG1420
16	SFERA 5/16 DIAM. 8 S1	2	---	AC1302K

VERSIONE BAC

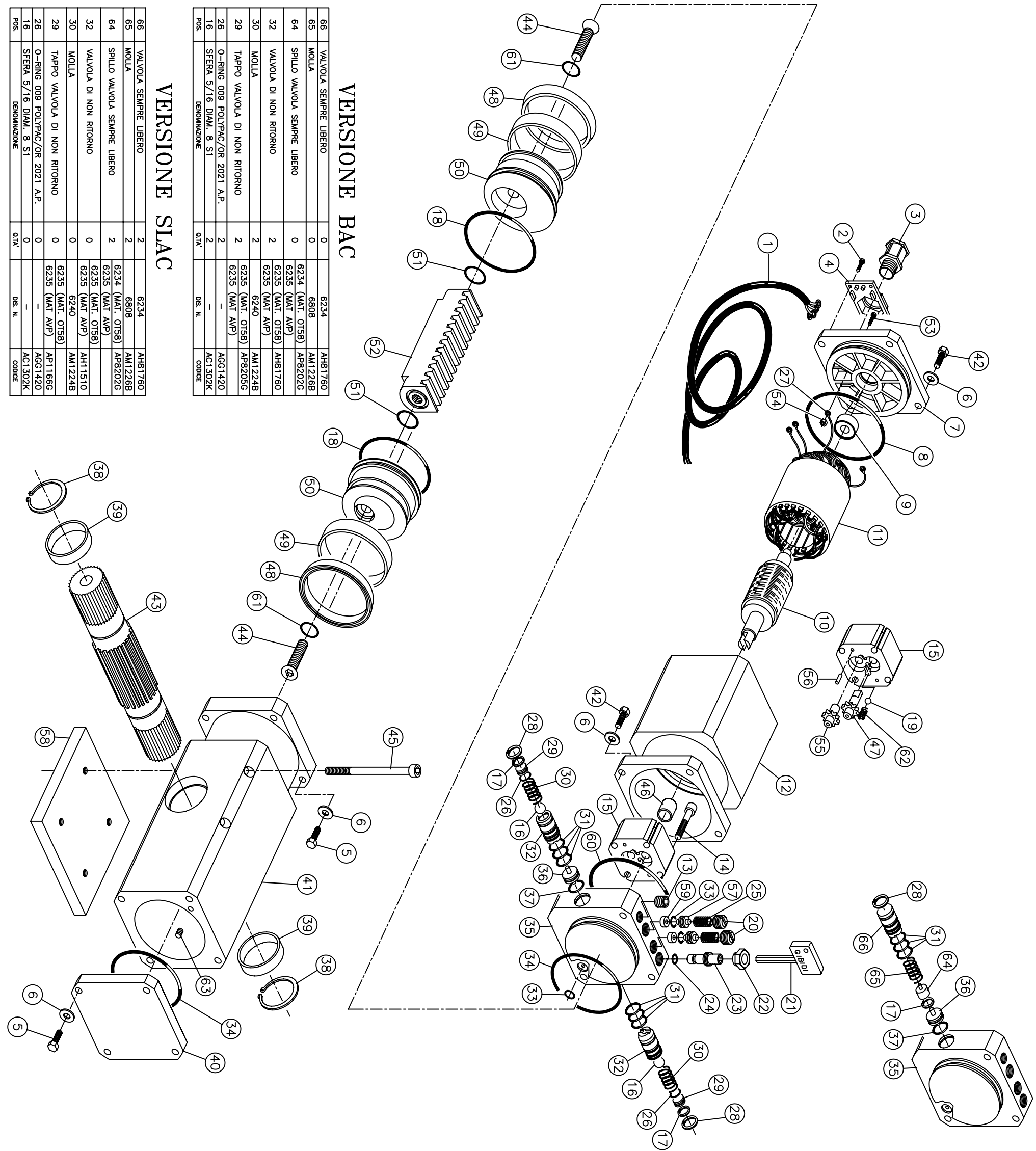

IDONEO PER LA PRODUZIONE
01/07/01

POS.	DENOMINAZIONE	Q.TA'	DIS. N.	CODICE	VEDI TABELLA A LATO
66	VALVOLA SEMPRE LIBERO	1	6234	AH81760	VEDI TABELLA A LATO
65	MOLLA	1	6908	AM1226B	VEDI TABELLA A LATO
64	SPILLO VALVOLA SEMPRE LIBERO	1	6234 (MAT. 0158)	AP8202G	VEDI TABELLA A LATO
63	GRANO 5x5 NERO UNI 5923	1	---	---	---
62	MOLLA 19x6,5x0,4	1	---	---	---
61	O-RING 015 POLYPAC/OR 2325 A.P.	1	---	---	---
60	O-RING 042 POLYPAC/OR 2325 A.P.	1	---	---	---
59	PASTIGLIA VALVOLA REGOLAZ. PRESS.	2	---	---	---
58	PASTIGLIA VALVOLA REGOLAZ. PRESS.	1	---	---	---
57	CURSORE	2	---	---	---
56	ROLLINO 3x9,8 ACC. CEMENT.	2	---	---	---
55	INGRANAGGIO	1	---	---	---
54	DADO M3 ZINC. UNI 5588 MEDIO	4	---	---	---
53	VITE M3x12 ZINC. 7985	8	---	---	---
52	CREMAGLIERA	1	---	---	---
51	O-RING 018 POLYPAC/OR 2075 A.P.	2	---	---	---
50	PISTONE	2	---	---	---
49	ANELLO DI GUIDA E/DWR 70	2	---	---	---
48	GUARNIZIONE MU/P 7060	2	---	---	---
47	INGRANAGGIO	1	---	---	---
46	BCCOLA 12x16x12	1	---	---	---
45	VITE M6x90 ZINC. UNI 5931	2	---	---	---
44	VITE M10x35 NERA UNI 5933	4	---	---	---
43	ALBERO CON DOPPIO PROFILO	1	---	---	---
42	VITE M6x18 ZINC. UNI 5739	1	---	---	---
41	CORPO CON INGRANAGGIO Z11	1	---	---	---
40	COFERCHIO	1	---	---	---
39	BRONZINA	2	---	---	---
38	SEGER E 35 UNI 7435	2	---	---	---
37	O-RING 111 POLYPAC/OR 3043 A.P.	1	---	---	---
36	CURSORE	1	---	---	---
35	DISTRIBUTTORE	1	---	---	---
34	O-RING 230 POLYPAC/OR 4250 A.P.	2	---	---	---
33	O-RING 610 POLYPAC/OR 106 A.P.	3	---	---	---
32	VALVOLA DI NON RITORNO	2	---	---	---
31	O-RING 014 POLYPAC/OR 2050 A.P.	6	---	---	---
30	MOLLA	2	---	---	---
29	TAPPO VALVOLA DI NON RITORNO	2	---	---	---
28	SEGER I 16 UNI 7437	2	---	---	---
27	CAPOCORONA DIAM. 6	4	---	---	---
26	O-RING 009 POLYPAC/OR 2021 A.P.	2	---	---	---
25	MOLLA	2	---	---	---
24	O-RING 008 POLYPAC/OR 2018 A.P.	1	---	---	---
23	CURSORE	1	---	---	---
22	TAPPO FERMO CURSORE	1	---	---	---
21	CHIAVE mm. 30	1	---	---	---
20	VALVOLA REGOLAZ. PRESSIONE	2	---	---	---
19	SFERA 7/32 Ø 5,55 S1	2	---	---	---
18	O-RING 839 POLYPAC/OR 167 A.P.	2	---	---	---
17	ANELLO SEGER 19 UNI 7437	2	---	---	---
16	SFERA 5/16 DIAM. 8 S1	2	---	---	---
15	CORPO POMPA DA L. 0,45	1	---	---	---
14	VITE M6x30 NERA UNI 5931	4	---	---	---
13	GRANO 10x8 A PUNTA ZINC. 5927	1	---	---	---
12	CORPO ACCOPP. POMPA-MOTORE	1	---	---	---
11	STATORE	1	---	---	---
10	ROTORE	1	---	---	---
9	CUSCINETTO 608	1	---	---	---
8	O-RING 846 POLYPAC/OR 177 A.P.	1	---	---	---
7	TESTATA	1	---	---	---
6	RONDELLA M6 ZINC. 6592	16	---	---	---
5	VITE M6x30 ZINC. UNI 5739	8	---	---	---
4	COFERCHETTO	1	---	---	---
3	PRESSACAVO PG. 11	1	---	---	---
2	VITE 2,9x13 INOX UNI 7981	4	---	---	---
1	CAVO DI ALIMENTAZIONE	1	---	---	---

GIBDI CONTINENTAL
POGGIO RUSCO
MANTOVA

COMPLESSIVO
PARTICOLARE
SCALA

MODULO 500
ESPLOSO

DATA 01/07/01
MODIFICATO 07/06/99

REVISIONI
4
1

7 4 2 2 2